

WIRE RANGE	E13288 Listed
22-16 AWG STRANDED	22-16 AWG STRANDED
LR7189 Certified	MILITARY P/N AND CLASS
NOT CERTIFIED	NOT APPLICABLE

STAMP AMP 22-18* APPROX AS SHOWN
22-16 TERMINALS ARE STAMPED 22-18 IN
ACCORDANCE WITH MILITARY SPECIFICATION
MIL-T-7928, COMMERCIAL WIRE RANGE IS 22-16

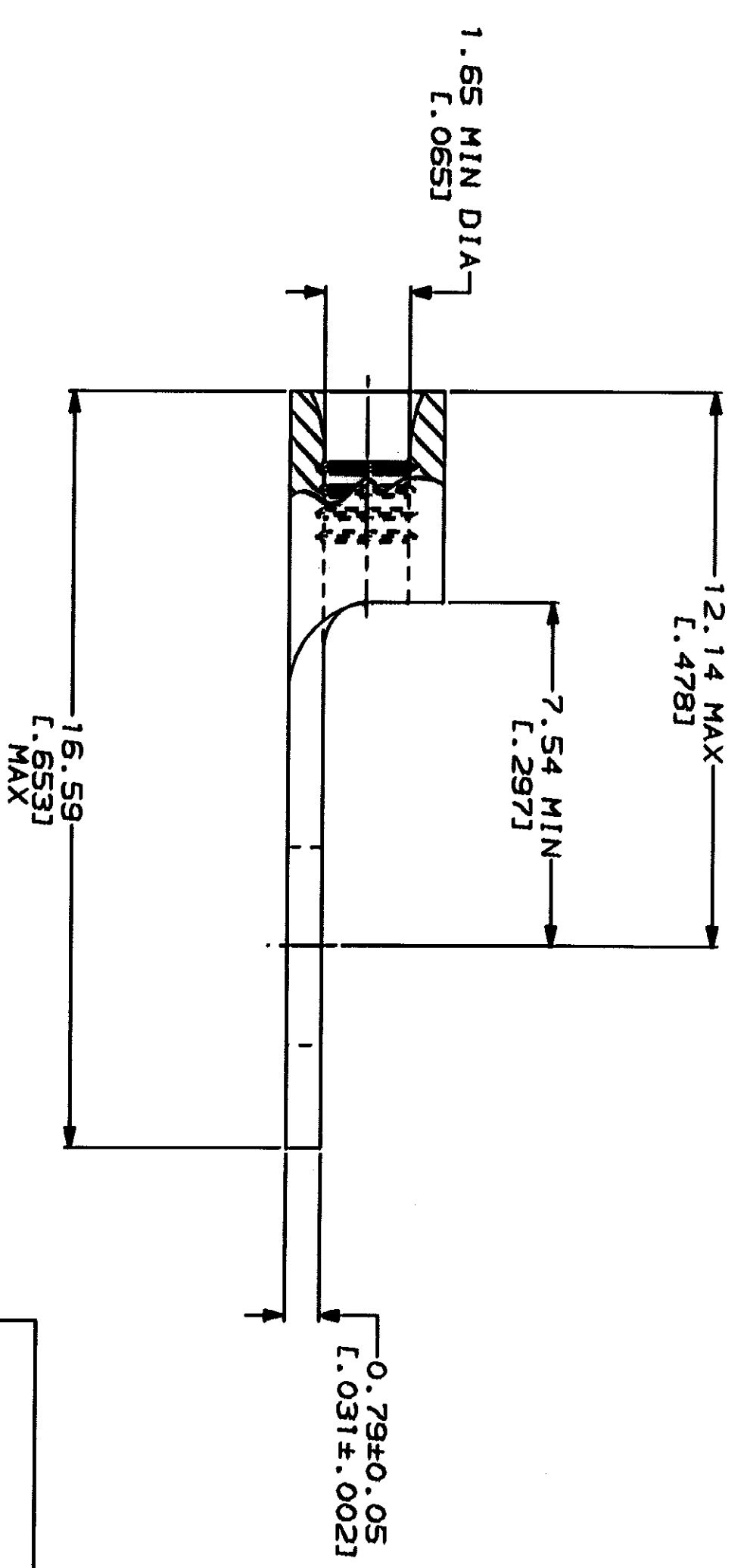

AMP INCORPORATED
CUSTOMER SERVICE SYSTEMS

FOR ADDITIONAL PRODUCT INFORMATION OR COPIES OF DRAWINGS AND TECHNICAL DOCUMENTS
1-800-522-6752

FOR APPLICATION TOOLING ASSISTANCE CENTER
1-800-722-1111

FOR ORDER ENTRY
1-800-526-5142

MAX RECOMMENDED OPERATING TEMPERATURE: 170°C MAX

VOLTAGE RATING: NOT APPLICABLE

WIRE CROSS SECTIONAL AREA RANGE: 0.26-1.65mm² [509-3,260] CIR MILS STRANDED

DO NOT SCALE PRINT. UNLESS SPECIFIED DIMENSIONS IN - - - - - THICKNESS TOLERANCES ON: 1. 2 PLG DEC ± . 3 ANGLES

FINISH: TIN PLATE 0.00254L.0001001 MIN THK PER MIL-T-10727

DR 2-26-93 TA BRILKMAN	NAME	AMP Incorporated Harrisburg, PA 17105-3508
CHK 2-26-93 DA PATTERSON	TERMINAL, RING TONGUE, BUDGET	
APPD 2-26-93 DE MILLER	SIZE	CAGE CODE
APPD 2-26-93 JL HECKLEY	00779	00779
PRODUCT SPEC	SCALE	8:1
APPLICATION SPEC	DRAWING NO	32823
WEIGHT	SHEET	1 OF 1